

# stand *apart*

HOLIDAY HOMES COLLECTION 2023



**VICTORY**  
LEISURE HOMES

# Welcome

TO OUR 2023 COLLECTION

"Our holiday homes have been designed to suit every holidaymaker. Whether you're a solo traveller looking to embark on an adventure with a good book and a pair of walking boots, or are wanting to unwind with your family and enjoy some al fresco dining on a summer evening, we understand what makes a home away from home.

"At Victory, we do things differently. We innovate and push the boundaries of design to curate a collection of leisure homes that are as unique as you.

"I hope you enjoy looking through this season's range and if you would like to find out more information, please don't hesitate to get in touch."

**Gary Corlyon,**  
**Managing Director**

[victoryleisurehomes.co.uk](http://victoryleisurehomes.co.uk)   [marketing@victoryleisurehomes.co.uk](mailto:marketing@victoryleisurehomes.co.uk)

## Contents

---

04

CREATING YOUR  
VICTORY

---

06

NOVUS

---

08

BUYER'S GUIDE

---

10

THE LAKEWOOD

---

16

THE RIVERWOOD

---

22

THE BOWER

---

28

THE LOCHWOOD

---

34

THE STONEWOOD

---

40

THE BAYWOOD



# Creating your Victory



## Innovation is in our DNA

Our team of innovation experts have turned traditional manufacturing processes on their head. From tweaks to interior configuration to working with our suppliers to develop materials that are more sustainable and future-proof - we never stand still in our commitment to give you the best holiday homes on the market.



## Quality craftsmanship

Quality is at the heart of everything we do. Our unrivalled craftsmanship is renowned across the country and our long-standing customers, with whom we've developed strong relationships, are a testament to this.

## You come first

Despite being one of the newest leisure home manufacturers in the UK, we're fast becoming the supplier of choice because of our reputation for customer service excellence. We aim to get it right first time. But on the rare occasion we might not, we make sure to put it right with no fuss. That's the Victory way.

## Two year warranty

The combination of solid construction and contemporary design, integrated with comfort and function, demonstrates the depth of knowledge and experience of the entire Victory team. This underpinning gives us the confidence to offer a two-year warranty to all purchasers within the UK subject to certain terms and conditions. For purchasers outside of the UK, please refer to your supplier for warranty details. The warranty available is additional to and does not affect your statutory rights under consumer legislation.



## Included as standard with your Victory:

- Novus wall system for a truly domestic look and feel throughout
- Novus composite floor to reduce bounce and save energy
- Top range models include our industry-leading lightweight, high-strength, fully galvanised chassis
- Sustainably-sourced materials to reduce the carbon footprint of all our products
- 100mm insulated roof
- 45mm wall insulation
- High compressive strength floor insulation
- Domestic gutters and downpipes
- Domestic interior doors and window frames
- Front and rear anthracite fascia and roof cappings
- Victory branded A class mattress
- Thermostatic shower mixer valve
- Low energy bulbs throughout and LED bulbs in all spotlights
- Steel pantile roof
- 10-year smoke detector and 2 carbon monoxide detectors
- Fire extinguisher and escape windows
- Exterior light near entrance

All features correct at time of print January 2023. Features and options subject to change.

## Accreditations

We're recognised by the best and partner with the best.





# Novus

## Stand apart with a Victory

The holiday home manufacturing process has been the same for decades. It has a reputation for being slow and 'behind the times'. Until now. Until Novus.

Novus is a construction process created by Victory that uses technology to improve manufacturing, bringing it firmly into the 21st Century. Think energy efficiency like never before. Think holidaying in a boutique hotel – with no more 'bouncing' floors or plastic joins on the walls, as you might experience in a traditional caravan. Think more space and contemporary design. Think Novus.

### What makes our homes different:

#### Floors

Fully bonded and insulated – removing bounce and reduced thermal bridging.  
Up to 100% thermal efficiency<sup>1</sup>

#### Walls

Beadless walls with structural I-beams for improved thermal efficiency and a true home from home feel.  
85% improved thermal efficiency<sup>2</sup>

Each of these small but important details provide a level of quality you've never seen before.

<sup>1</sup> Based on current BS3632 Residential Park Homes Spec.  
<sup>2</sup> At wallboard joints  
<sup>3</sup> Per square metre

#### Roof

Structurally-graded trusses with grade B snow loading.  
Can hold up to 150kg of snow<sup>3</sup>

#### Ceiling

Tongue & groove panelling for a truly domestic look.  
Feels more like a home.

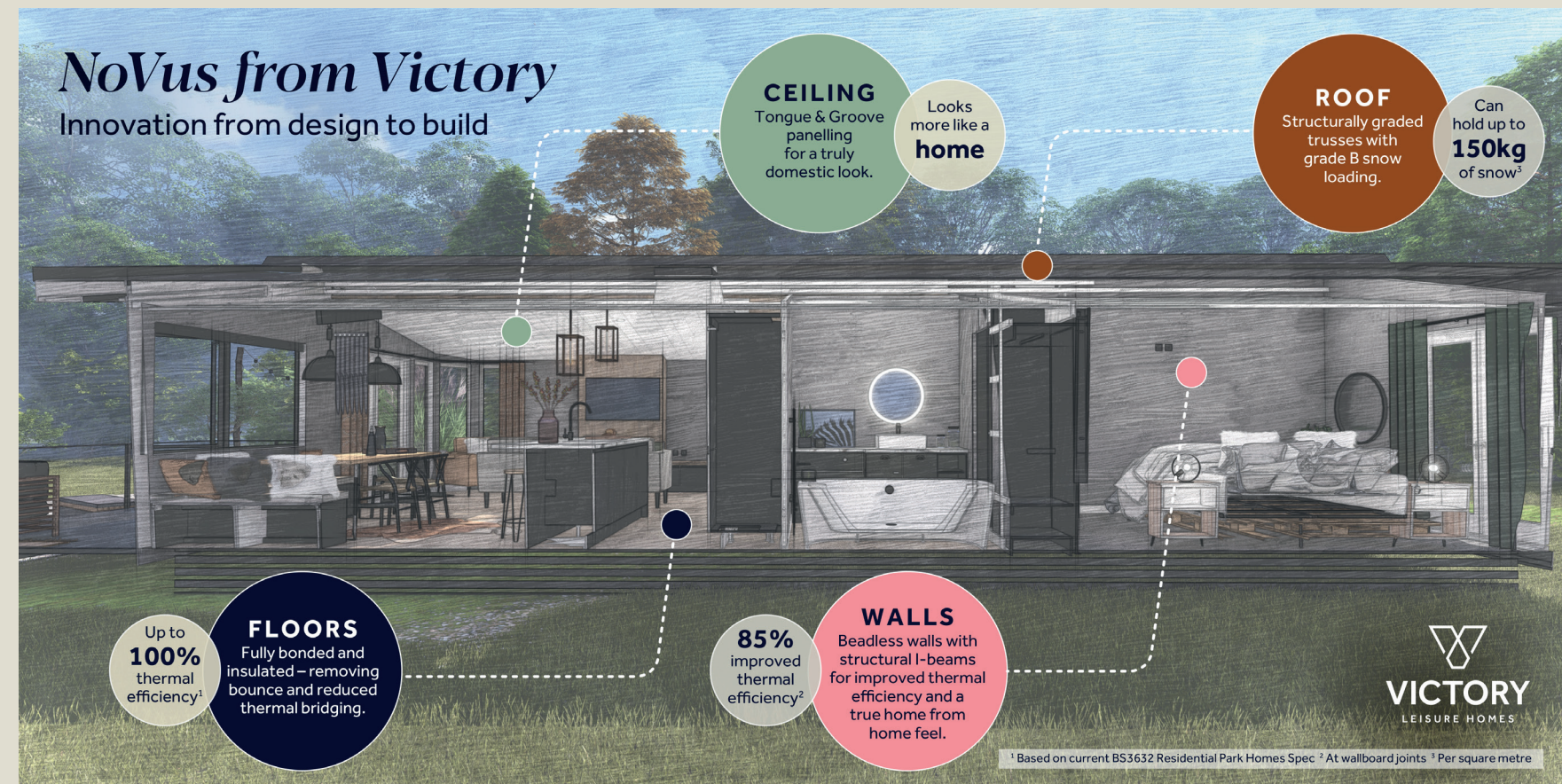

<sup>1</sup> Based on current BS3632 Residential Park Homes Spec. <sup>2</sup> At wallboard joints <sup>3</sup> Per square metre





# Buyer's guide

## HOW TO BUY YOUR VICTORY

If you've always dreamed of owning a holiday home or lodge but don't know where to start, we've made it easier with our guide. From budgets to beach views, and pricing to pitch size - we've considered everything so you don't have to.

Before you make a decision, do your research to make sure your budget matches what you need and want. Consider things like insurance, whether you're renting it out, and how you might finance it.



### STEP 1

#### Find your dream location

Finding your holiday park is the first step in your decision to holiday home ownership. As a rule of thumb, we suggest sticking within a 2-3 hour drive of where you live, to make sure it's easy to make the most of your new dream home away from home. Visit the park and experience the on-site facilities. In other words, try before you buy!



### STEP 2

#### Choose your dream home

Our homes have been designed to suit a range of tastes and you're able to customise and add a variety of features to suit your needs. Do you need an en-suite? Do you want open plan or central lounge? Do you prefer a bath or shower? Do you love cooking up a storm in the kitchen? Will you have people staying over? And if you want to see our selection of holiday homes and lodges in person, visit our showground in East Yorkshire.



### STEP 3

#### Pick your dream pitch

Choose a pitch that suits you. You'll need to consider the size of your pitch, your view, parking, and how close you are to the facilities.



### STEP 4

#### Place your order

Place your order with one of our trusted parks or dealerships and we'll start hand-crafting your home in our factory.





# THE Lakewood

The Lakewood is our flagship model for a reason. Perfect for entertaining, the Lakewood Lodge is designed to bring family and friends together. Its modern open-plan design with front aspect French doors and windows offer a real sense of space, while the kitchen area features integrated appliances, a large dining area, and a slick handleless finish. An en-suite adjoins the statement master bedroom and, with a second bedroom and bathroom also included, there's room for all the family.

Unpack your bags, relax and put your feet up. Let the Lakewood transport you to your dream holiday.

## Key features:

- Contemporary open-plan living space
- VELUX roof windows
- Luxurious master bedroom with walk-in wardrobe and en-suite shower
- Integrated appliances
- Freestanding lounge furniture



Scan to view full specification,  
or visit [victoryleisurehomes.co.uk](https://victoryleisurehomes.co.uk)











# Lakewood

## FLOOR PLANS

Scan to view full specification,  
or visit [victoryleisurehomes.co.uk](https://victoryleisurehomes.co.uk)



The Lakewood is also available in BS3632 Residential Specification.

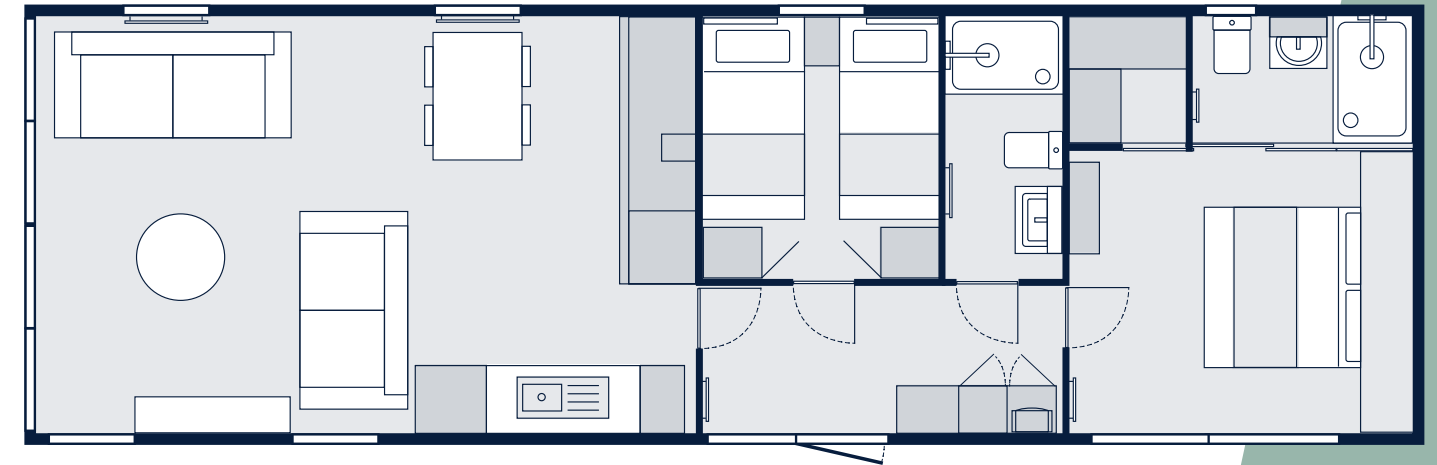

1. 42 ft x 13 ft 2 Bedrooms

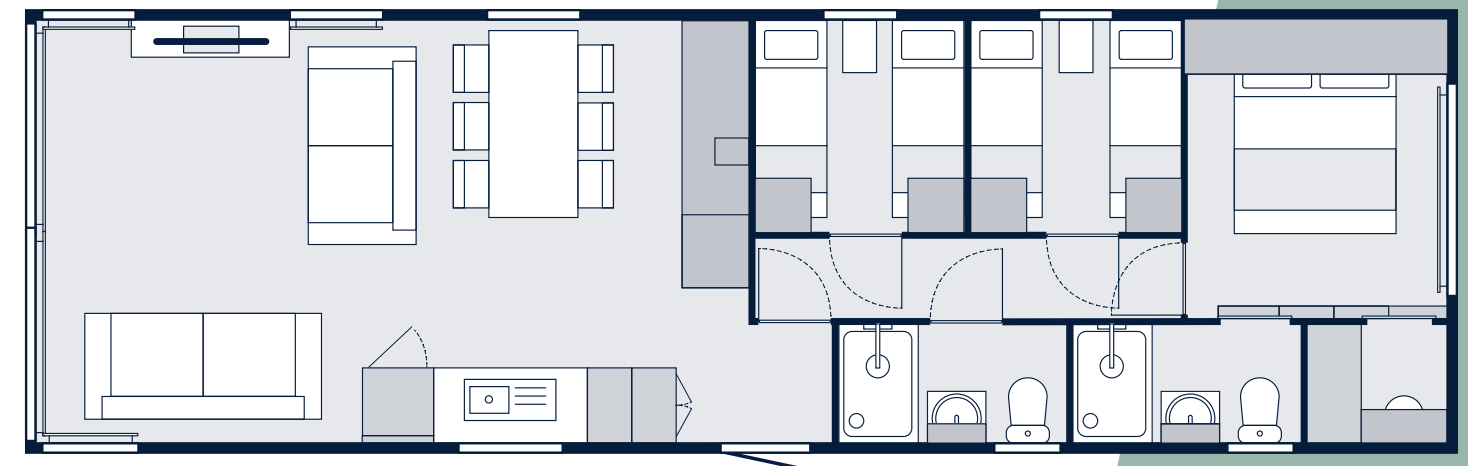

2. 43 ft x 14 ft 3 Bedrooms



# THE Riverwood

If you're looking to holiday in style, look no further than the Riverwood. With a boutique, luxury feel, the Riverwood boasts a Moroccan-inspired design with statement fabrics, sleek black accessories, pendant lighting and gold accent handles throughout. The master bedroom features a dressing area and ensuite so you can get ready in style. Available in two or three bedroom options, there's plenty of space for additional family members or guests.

It's time to staycation in style.

## Key features:

- Striking interior design
- Contemporary freestanding lounge furniture
- Integrated kitchen appliances and a half bowl Reginox caststone sink
- Available in two or three bedroom models



Scan to view full specification,  
or visit [victoryleisurehomes.co.uk](https://victoryleisurehomes.co.uk)







A boutique  
level of  
*Luxury*







# Riverwood

## FLOOR PLANS

Scan to view full specification,  
or visit [victoryleisurehomes.co.uk](https://victoryleisurehomes.co.uk)



The Riverwood is also available in BS3632 Residential Specification.

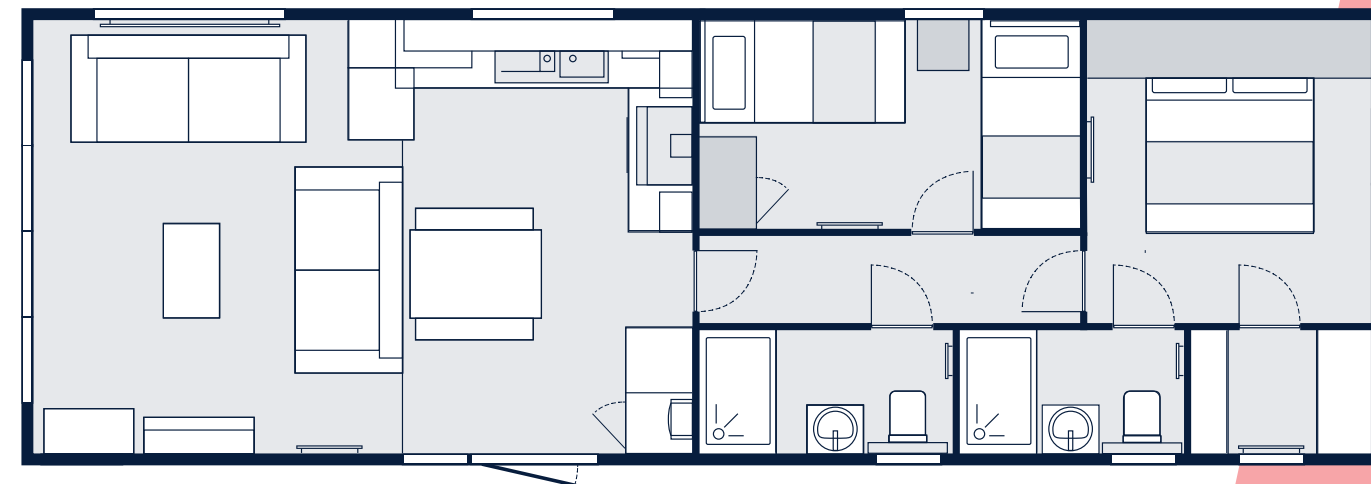

1. 40 ft x 13 ft 2 Bedrooms

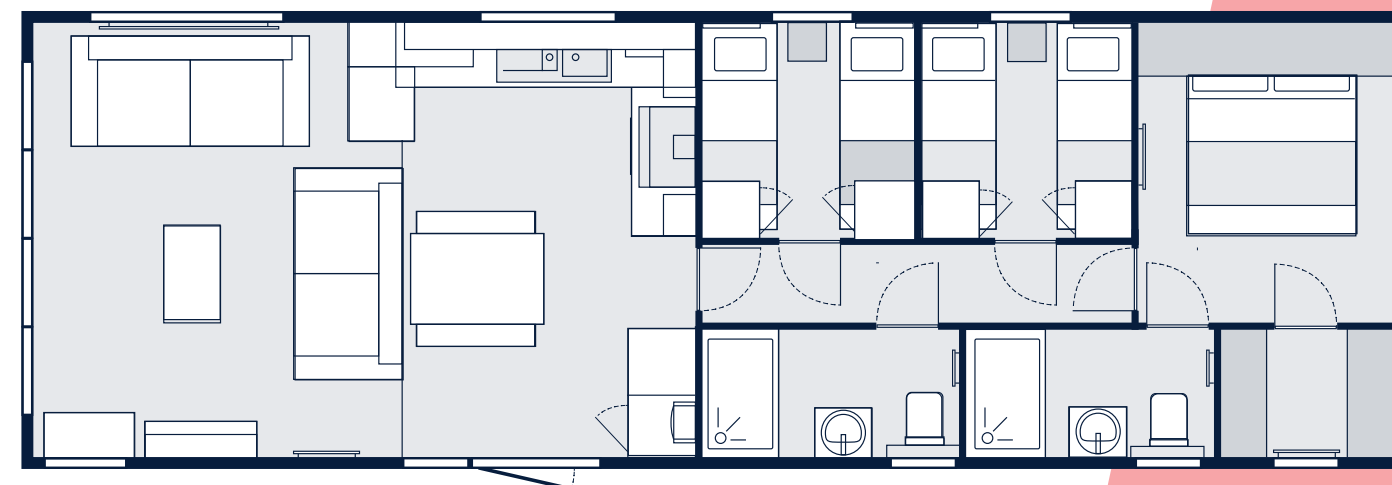

2. 41 ft x 13 ft 3 Bedrooms



# THE Bower

The Bower has been designed with families in mind and has all the room you need to make treasured memories that will last a lifetime. The modern, on-trend design has been created so you can add your own finishing touches. It's also easy-clean, so you don't need to worry about sandy feet (or paws) or sticky fingers. You'll be spoilt for storage throughout. There's plenty of space to cook up the finest family meals – we've even made room for a highchair in the dining area so everyone can enjoy their holiday. With sockets in the perfect place (for baby monitors or hairdryers), and a large family seating area, you won't want to come home.

Park up, tuck your suitcases away, and relax – your perfect family holiday starts in the Bower.

## Key features:

- Plenty of storage space
- Stylish interiors with on-trend features
- Dim out curtains and blinds
- Family friendly and easy clean fabrics



Scan to view full specification,  
or visit [victoryleisurehomes.co.uk](https://victoryleisurehomes.co.uk)











# Bower

## FLOOR PLANS

Scan to view full specification,  
or visit [victoryleisurehomes.co.uk](https://victoryleisurehomes.co.uk)

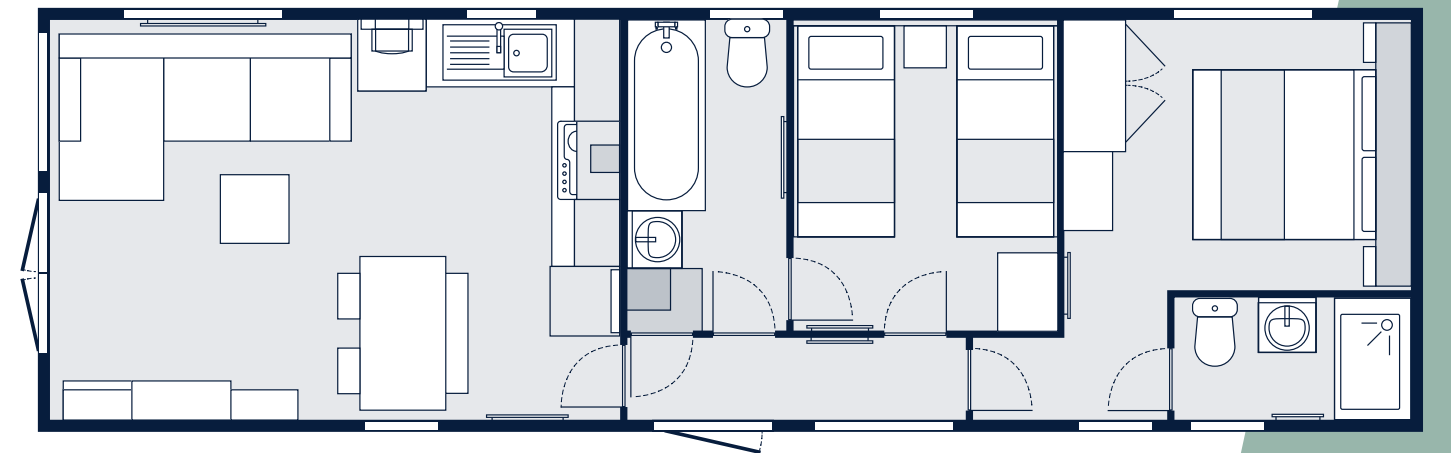

1. 40 ft x 12 ft 2 Bedrooms

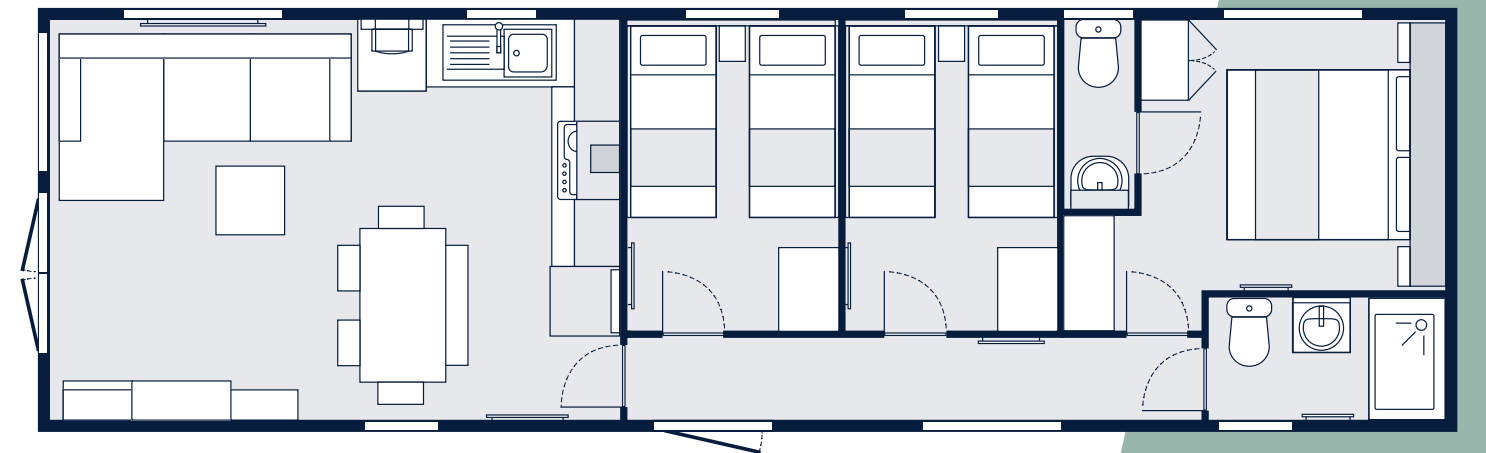

2. 41 ft x 12 ft 3 Bedrooms



# THE Lochwood

If you're looking for sumptuous living with clever, space-saving design, the Lochwood has everything you need. Designed for families who are looking for a contemporary yet functional space, perfect for hosting and relaxing. The Lochwood boasts an L-shaped sofa - which is perfect for movie nights - as well as a master suite with an en-suite.

Grab your picnic blanket, the outdoors is calling.

## Key features:

- A modern galley kitchen
- Large L-shaped sofa
- King size master bed and ample storage
- Available in two or three bedroom models



Scan to view full specification,  
or visit [victoryleisurehomes.co.uk](https://victoryleisurehomes.co.uk)







Sumptuous open  
plan *Living*





# Lochwood

## FLOOR PLANS

Scan to view full specification,  
or visit [victoryleisurehomes.co.uk](https://victoryleisurehomes.co.uk)

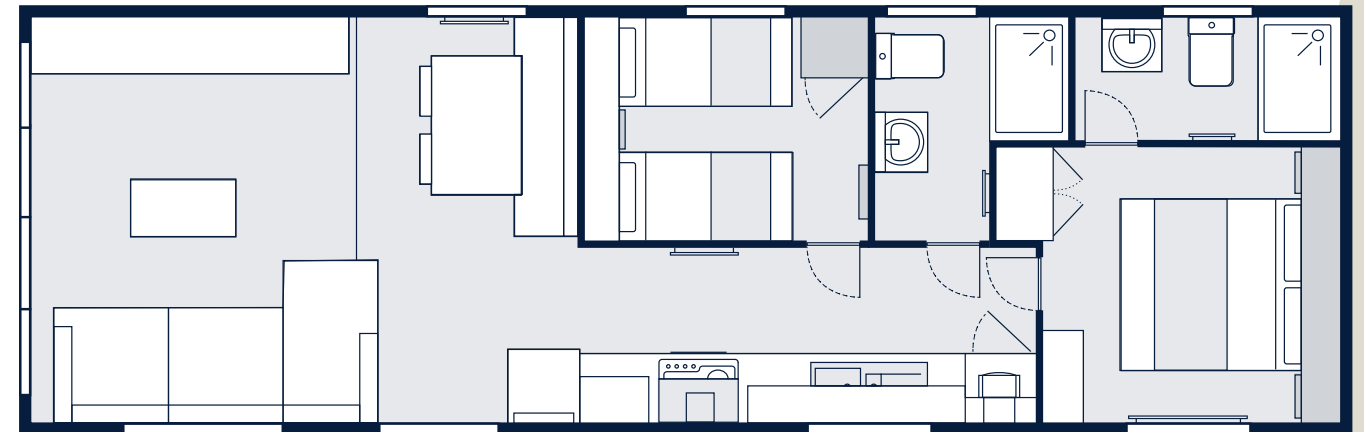

1. 38 ft x 12 ft 2 Bedrooms

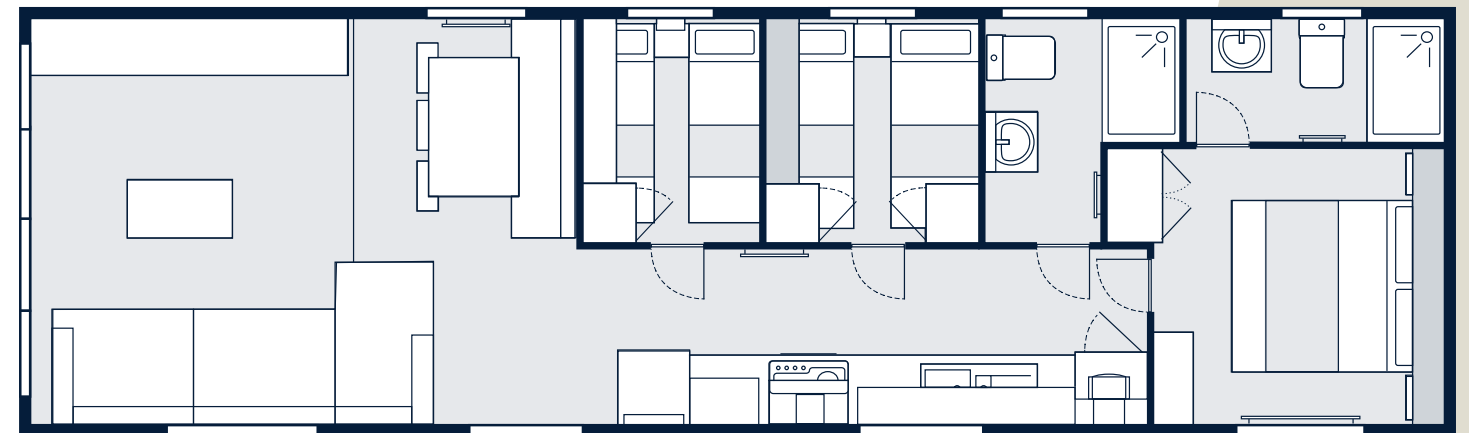

2. 41 ft x 12 ft 3 Bedrooms



# THE Stonewood

Comfortable, charming and cosy, the Stonewood is a high-quality and affordable option to create holiday memories for years to come.

With a large kitchen/dining area, guests at the Stonewood can gather around the modern bench seating or whip up a feast in the kitchen. Contemporary open storage adds style and practicality to the bedrooms, and the easy to maintain bathroom comes complete with everything you need to enjoy holidaying your way in the Stonewood.

## Key features:

- Available in a range of model sizes
- Lots of natural light
- L-shaped sofa with plenty of storage
- Neutral wood tones throughout



Scan to view full specification,  
or visit [victoryleisurehomes.co.uk](https://victoryleisurehomes.co.uk)







A  
*modern*  
traditional  
holiday home







# Stonewood

## FLOOR PLANS

Scan to view full specification,  
or visit [victoryleisurehomes.co.uk](https://victoryleisurehomes.co.uk)

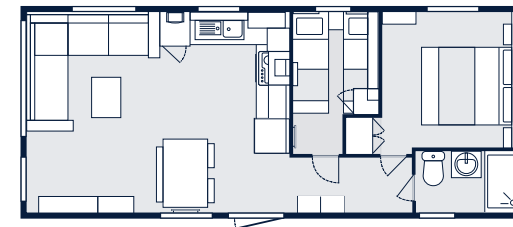

1. 29 ft x 12 ft 2 Bedrooms

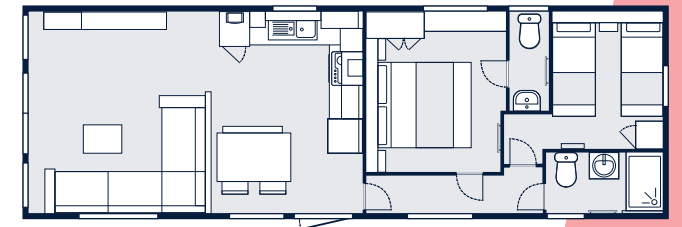

4. 37 ft x 12 ft 2 Bedrooms

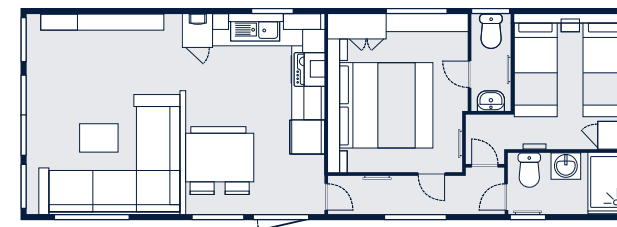

2. 35 ft x 12 ft 2 Bedrooms

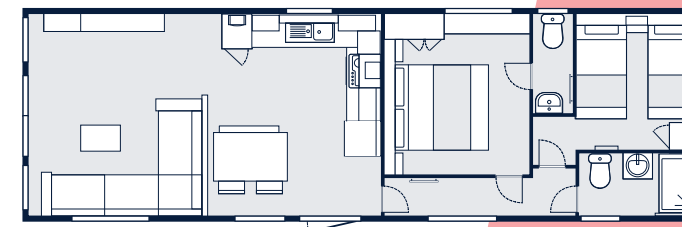

5. 39 ft x 12 ft 2 Bedrooms

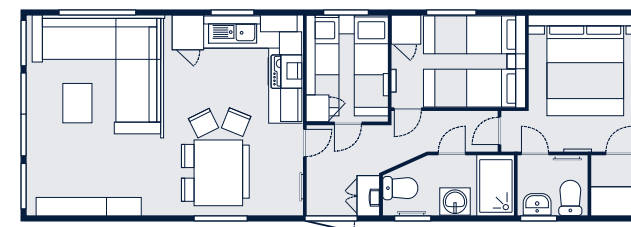

3. 36 ft x 12 ft 3 Bedrooms

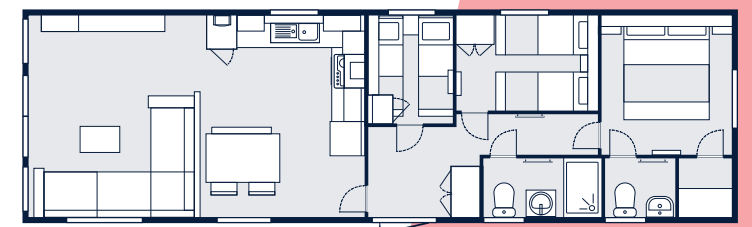

6. 41 ft x 12 ft 3 Bedrooms



# THE Baywood

Packed with everything you could possibly need, the Baywood holiday home is perfect for young families and first-time buyers who want to escape the everyday and staycation in style. With a range of layouts, an on-trend colour scheme, and plenty of storage and holiday must-haves, the Baywood offers fuss-free family holidays and a lifetime of memories. So pack your board games, stuff your cases, and start your adventure.

## Key features:

- Available in a range of model sizes
- Lots of natural light
- L-shaped sofa with plenty of storage
- Neutral wood tones throughout

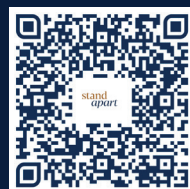

Scan to view full specification,  
or visit [victoryleisurehomes.co.uk](https://victoryleisurehomes.co.uk)











# Baywood

## FLOOR PLANS

Scan to view full specification,  
or visit [victoryleisurehomes.co.uk](https://victoryleisurehomes.co.uk)

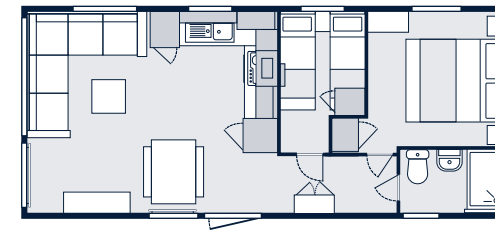

1. 28 ft x 12 ft 2 Bedrooms

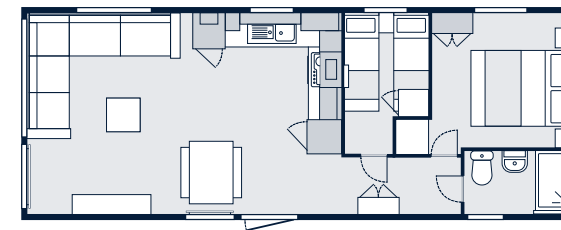

2. 32 ft x 12 ft 2 Bedrooms

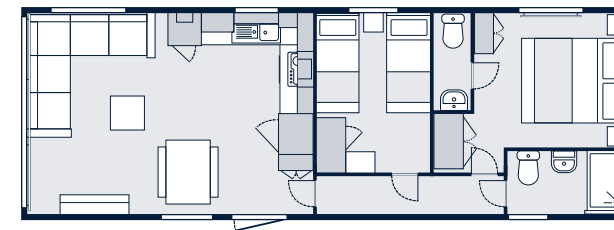

3. 35 ft x 12 ft 2 Bedrooms

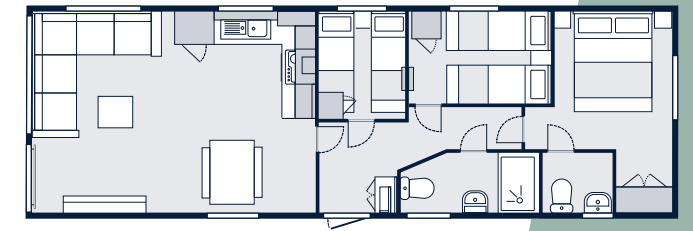

4. 36 ft x 12 ft 3 Bedrooms

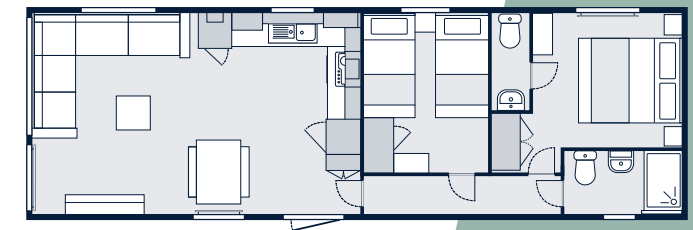

5. 38 ft x 12 ft 2 Bedrooms

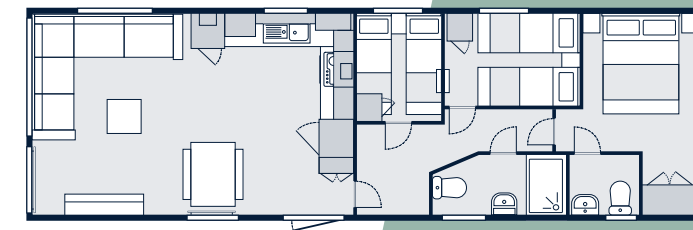

6. 39 ft x 12 ft 3 Bedrooms





# JOIN THE VICTORY *Family*

Scan to join the Victory Family,  
or visit [victoryleisurehomes.co.uk](https://victoryleisurehomes.co.uk)



## JUST SOME OF THE BENEFITS YOU'LL ENJOY



Chat with other Victory owners and  
share tips and advice



Be among the first to meet our  
new additions to the family



Get a unique family pack with the  
essentials you need to make your  
holiday **home**



Share your Victory memories  
with us on social media

Your holiday home is your sanctuary, your  
party spot, your family hub. It's more than a  
destination, it's a place in your heart. Memories  
that will last generations are made and shared  
here. Join the Victory Family and make your  
holiday, **home**.

# VISIT OUR SHOWGROUND

Whether you're a first time buyer, seasoned  
holiday home owner, or trade customer, our  
showground is the perfect place to find your  
next Victory. Set in the heart of the East  
Yorkshire countryside, with easy access to the  
M62, our friendly team are waiting (with the  
kettle on) to answer your questions and show  
you around.

Our state-of-the-art Experience Centre is the perfect place to  
take it all in and ask about ownership, the best parks, or simply  
to spend an hour in a home to see if it's the right one for you. We  
can't wait to see you...

To make sure you have all the time you need to look around the  
homes and chat to our team, we need 7 days notice for any  
appointments.

## Book your appointment



Scan to book an appointment,  
or visit [victoryleisurehomes.co.uk](https://victoryleisurehomes.co.uk)

**OPEN WEEKDAYS  
10AM - 2PM**





Broad Lane, Gilberdyke, East Yorkshire, HU15 2TD  
01430 471200 [marketing@victoryleisurehomes.co.uk](mailto:marketing@victoryleisurehomes.co.uk)

This brochure is designed to provide an illustrative representation of our homes. Some colours may be affected in digital print. All features correct at time of issue (January 2023) but are subject to change - the most up to date product specifications can be found on our website [victoryleisurehomes.co.uk](https://www.victoryleisurehomes.co.uk)